

Spare Part Kit for Back Pressure Regulator

A-83.590.140

swan
Analytical Instruments

SWAN ANALYTISCHE INSTRUMENTE AG, CH-8340 Hinwil
TEL. +41 44 943 63 00, FAX +41 44 943 63 01 e-mail swan@swan.ch

Contents

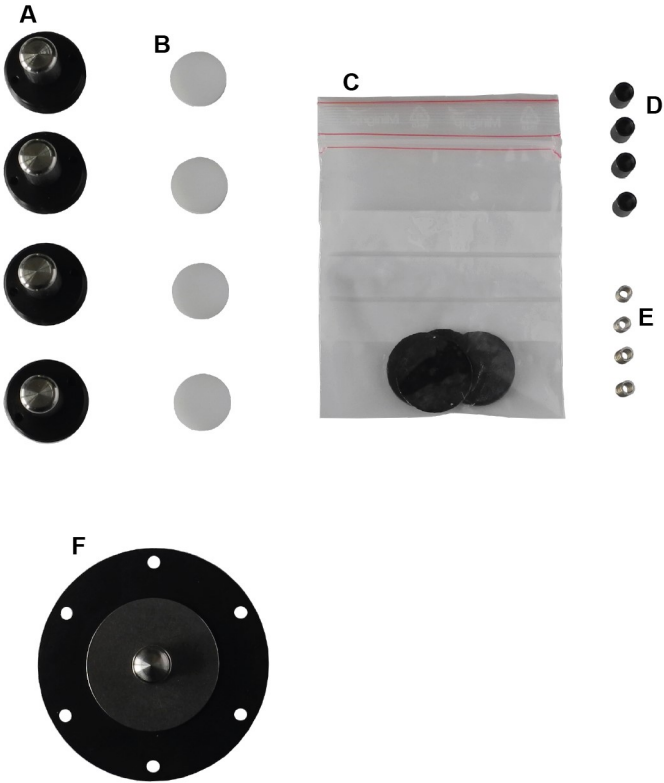

A Pressure screws
B Pressure discs
C Valve membranes

D Tappets
E Compressing springs
F Membrane

Required tools and materials:

- Circlip pliers
- Torque screwdriver

Replacing the membrane

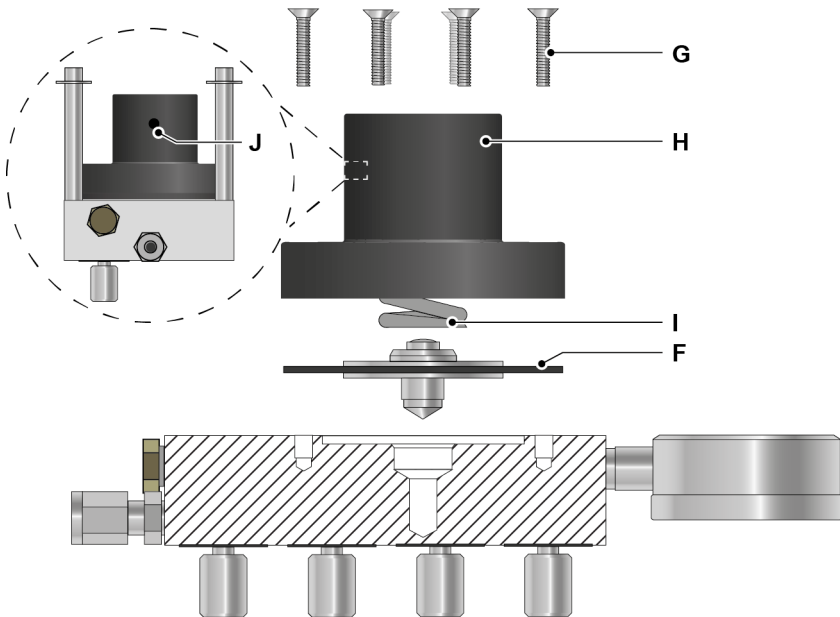

1. Loosen all 6 screws [G] and remove the membrane housing [H].
NOTICE: Press down the membrane housing while loosening the screws so that the spring [I] does not pop out.
2. Remove the old membrane.
3. Insert the new membrane [F].
4. Place the housing on the membrane. Ensure the correct position of the hole [J] as shown in the image.
5. Tighten the 6 screws in a crosswise sequence first with 30 Ncm and then with 120 Ncm.

Replacing the valve cores

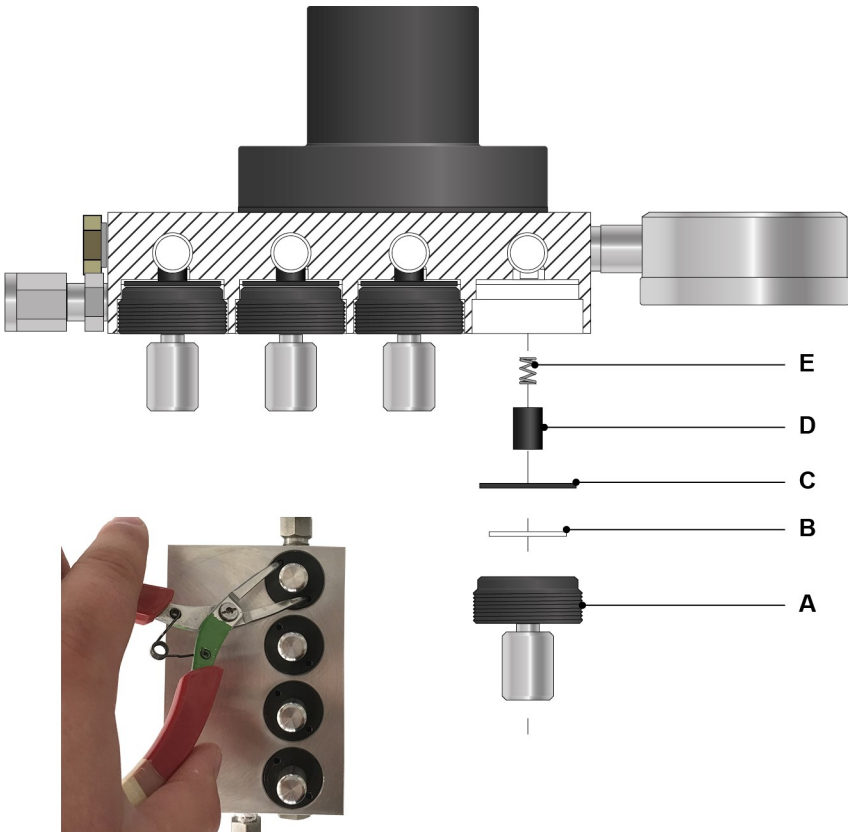

6. Use a pair of circlip pliers to remove the old valve cores.
7. Install the parts as shown in the image. Align the membranes [C] with the smoother side to the valve seat.